



**Customer focus that's a state-of-mind.
Customer resources that are state-of-the-art.**

The Sandell Construction Solutions Answer Center:

For technical support and specification information, call toll-free:
1-800-283-3888

Web site:

For complete details on product performance and specifications visit:
www.sandellmfg.com

Regional Locations:

Sandell Manufacturing Co., Inc.

Corporate Office
310 Wayto Road
Schenectady, NY 12303
Toll-Free: 1-800-283-3888
PH: (518) 357-9757
FX: (518) 357-9636
Email: moreinfo@sandellmfg.com

Branch Office - AL

829 - 34th Street North
Birmingham, AL 35222
Toll-Free: 1-877-SANDELL (786-3355)
PH: (205) 263-1030
FX: (205) 263-1033

Branch Office - IL

5401 W. 65th Street
Bedford Park, IL 60638
PH: (708) 594-2995
(708) 594-2996
FX: (708) 594-2998

**Information
Speed
Expertise**



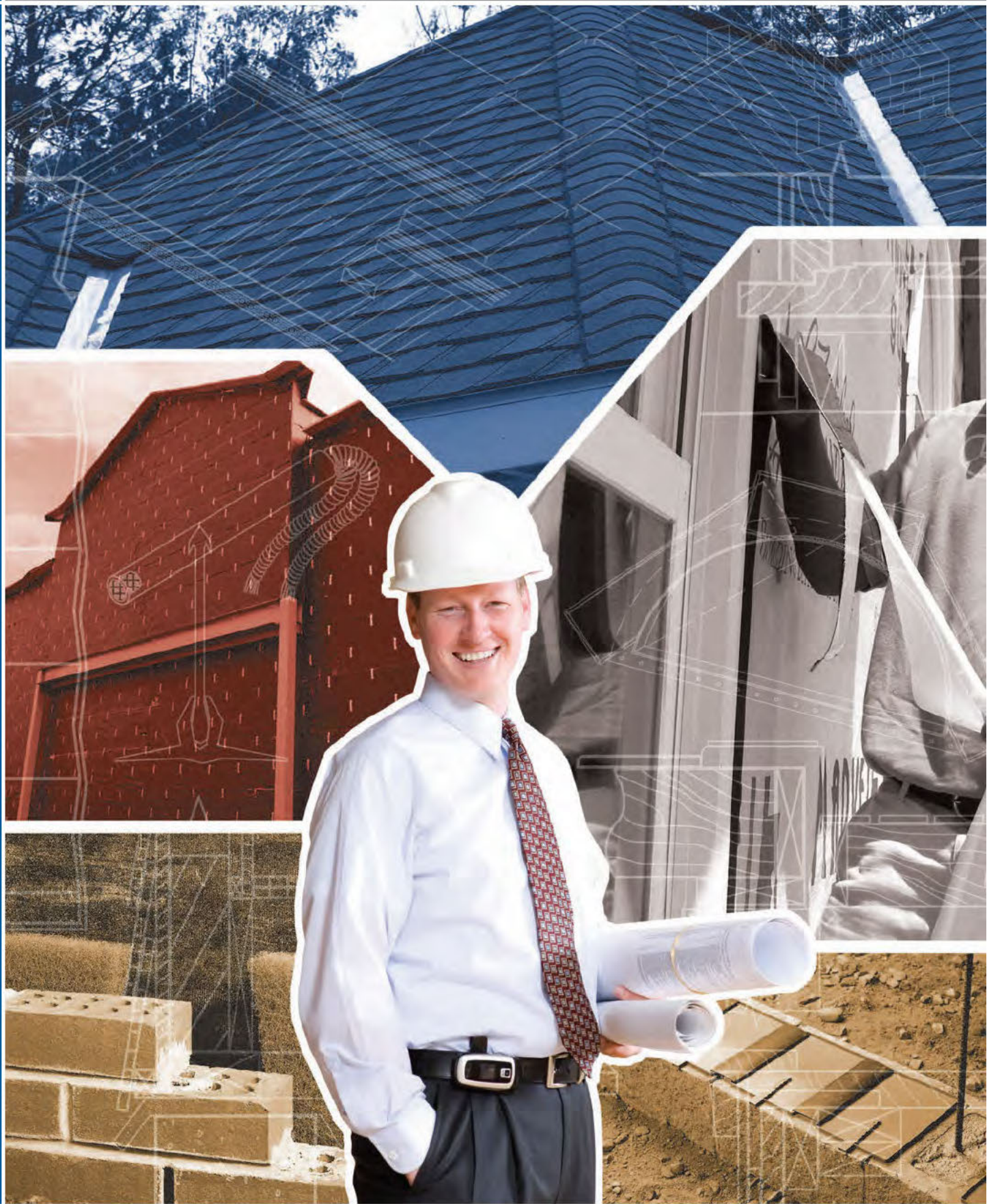

SANDELL®
CONSTRUCTION SOLUTIONS
System Reliability Built In



- 1** We make the products that make your commercial building system work.
- 3** The demands of commercial building demand more than just a product.
- 5** Commercial Building Solutions
 - 5** Why Copper?
 - 7** Why Pre-Formed Flashing & Metal Systems?
 - 9** Why Synthetic Flashing Systems & Accessories?
 - 11** Why Flashing Mastics & Primers?
 - 13** Why Masonry Anchors & Accessories?
 - 17** Why Masonry & Concrete Accessories?
 - 20** Why Thermal Expansion & Control Joint Products?
 - 23** Why Weeps & Drainage?
 - 25** Why Sandell's Air-Tight™ Systems?
- 27** Customer success is our focus.
- 29** Customer resources that are state-of-the-art.



We make the products that make your commercial building system work.

Ours is a less-than-perfect world. Today's buildings require performance and protection within a wide range of harsh environmental conditions – rainwater penetration, wind-driven water, moisture ingress and moisture build-up, drainage, vapor flow, condensation and capillary transfer – that are the enemies of structural and climatic integrity. Damage from rot, decay, mold and cracking are the outcomes of a less-than-perfect combination of engineering, science and sealing design.

Sandell Construction Solutions combine to create the primary and the best line of defense to complement a building's structural components in meeting severe environmental challenges “behind the scenes” – outside and inside the drainage plane – between the wet and dry zones of the building envelope. Our unmatched commitment to reliability is built in to your enclosure system applications because it's built in to every Sandell product.

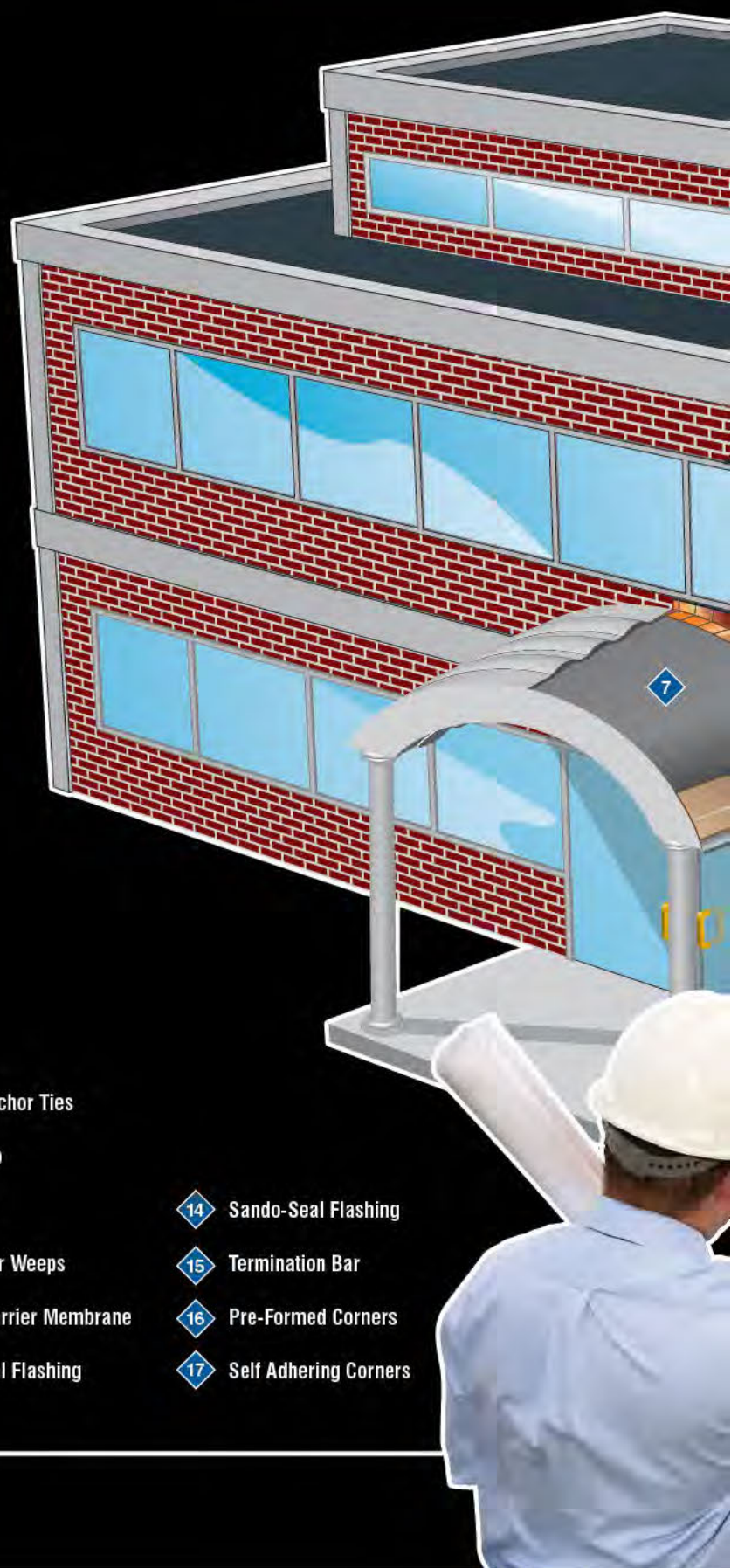

- | | | |
|-----------------------------|-------------------------------|--------------------------|
| 1 Air-Tight Spray-On | 8 Triangle Anchor Ties | |
| 2 Trowel Mastic | 9 Mortar Web | |
| 3 Drip Edge | 10 Cell Vents | 14 Sando-Seal Flashing |
| 4 Step Flashing | 11 Rectangular Weeps | 15 Termination Bar |
| 5 Copper Thru-Wall Flashing | 12 Air-Tight Barrier Membrane | 16 Pre-Formed Corners |
| 6 Granular IceGuard | 13 Rubber Seal Flashing | 17 Self Adhering Corners |
| 7 Metal Guard | | |

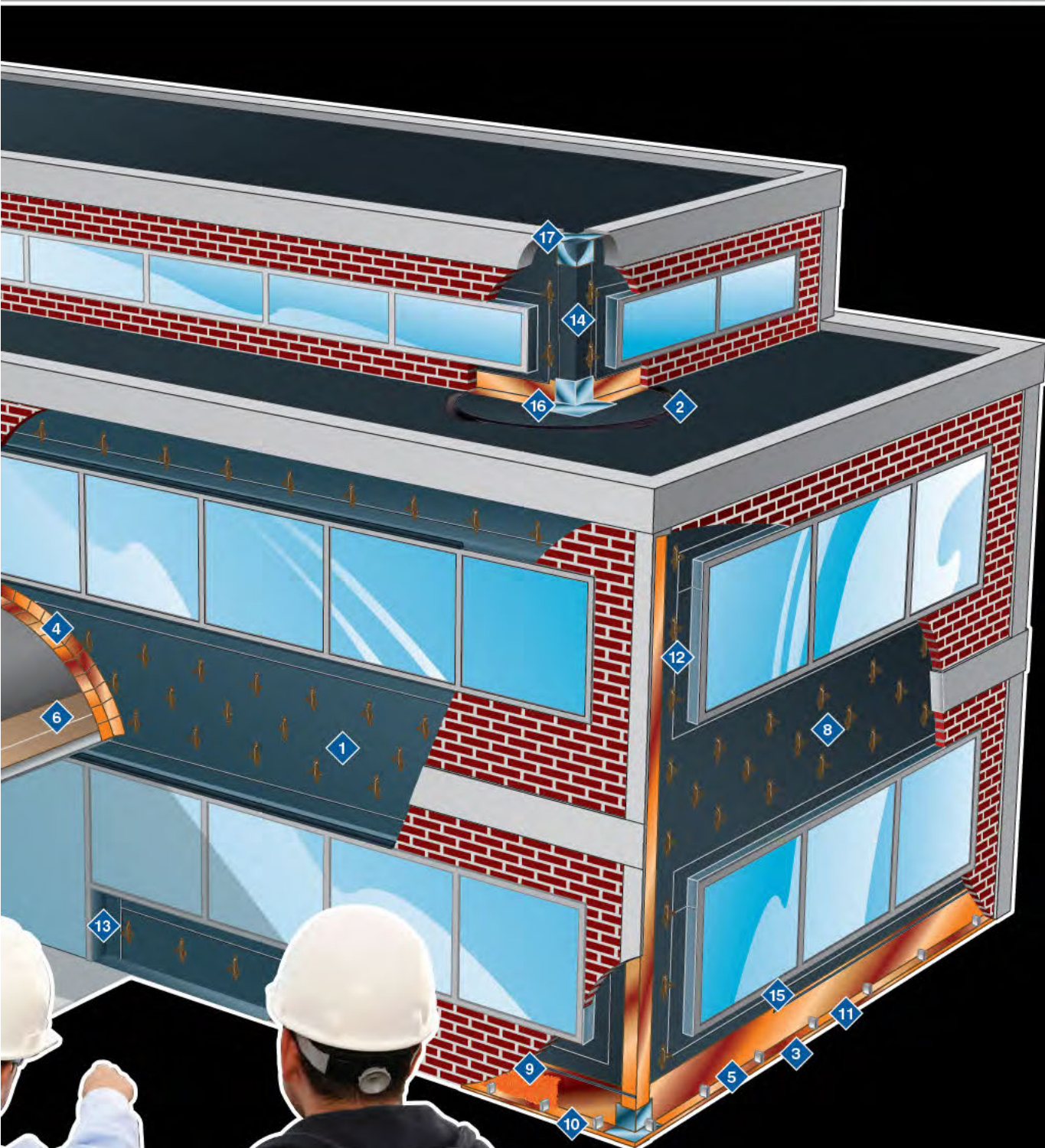

ORDER NO.

Cell Ve
Copper
Drip Ed
Flash-
Granul
Metal
Mortar
Mortar
Mortar
Nuflex
Presto
Rectan
Rubber
Sando-
Shingle
Sill Se
Termin
Weep T

The demands of commercial building demand more than just a product.

**Quality is our promise.
Service is our guarantee.
Reliability is our solution.**



The building process is one of trust. We understand that commercial structures must stand up to Mother Nature and must stand up to the test of time.

For more than 70 years, Sandell Construction Solutions has built its reputation on combining product innovation, fabricating excellence and customer service leadership, as well as by investing in technology and support that add value to commercial projects from the simple to the complex.







Why Copper?

Its high corrosion resistance, minimum maintenance requirements and good economy make Sandell's copper laminate flashing ideal for your commercial flashing needs. After working extensively with copper for over 70 years, Sandell knows that copper, with its unfailing characteristics, is the best flashing choice – offering cost-effective, reliable protection for the life of the structure.



Coated Copper Flashing

Sandell's Coated Copper Flashing is a full sheet of copper, laminated on both sides with a rubberized asphalt. This combination guarantees a permanent bond, along with incredible flexibility. The sheet copper is protected from acids, alkaline and electrolysis.

Weights:

- ◆ 2 oz., 3 oz., 5 oz., 7 oz. and 10 oz.

Sizes:

- ◆ Custom widths between 12" – 36"
- ◆ Can be cut into multiple widths

Copper Fabric Flashing

Avoid galvanic corrosion – use copper! This product is a superior waterproofing material of the highest quality. Sandell's Copper Fabric Flashing is composed of a full sheet of copper foil, laminated on both sides with a treated glass fabric. The materials are then bonded under pressure with a custom-blended asphalt.

Weights:

- ◆ 2 oz., 3 oz., 5 oz., 7 oz. and 10 oz.

Sizes:

- ◆ Custom widths between 12" – 36"

Copper Fabric Flashing NA

Choose Sandell's Copper Fabric Flashing NA for all the performance of copper, with none of the problems of asphalt – now in lighter, longer rolls for fewer lap joints, and reduced opportunity for failure. It's clean and flexible, works in all temperatures and won't get brittle or soften.

Weights:

- ◆ 2 oz., 3 oz., 5 oz., 7 oz. and 10 oz.

Sizes:

- ◆ Custom widths between 12" – 36"
- ◆ In rolls 25' or 60' long

Copper Kraft Duplex Flashing

Sandell's Copper Kraft Duplex Flashing exhibits the flexibility and strength of copper. Under high pressure the copper is saturated in a waterproofing asphalt bath. The product is then laminated on both sides with a reinforced Kraft paper to allow for easy installation.

Weights:

- ◆ 2 oz., 3 oz., 5 oz., 7 oz. and 10 oz.

Sizes:

- ◆ Custom widths between 12" – 36"
- ◆ In rolls 25' or 60' long

Copper Kraft Flashing

Avoid galvanic corrosion – use copper! Low in cost and easy to handle, Sandell's Copper Kraft Flashing includes a full sheet of copper that is laminated on one side with a reinforced Kraft paper. It is bonded together under high pressure with a special blend of waterproofing elastomeric asphalt, and recommended for curtain wall and frame construction.

Weights:

- ◆ 2 oz., 3 oz., 5 oz., 7 oz. and 10 oz.

Sizes:

- ◆ Custom widths between 12" – 36"
- ◆ In rolls 25' or 60' long

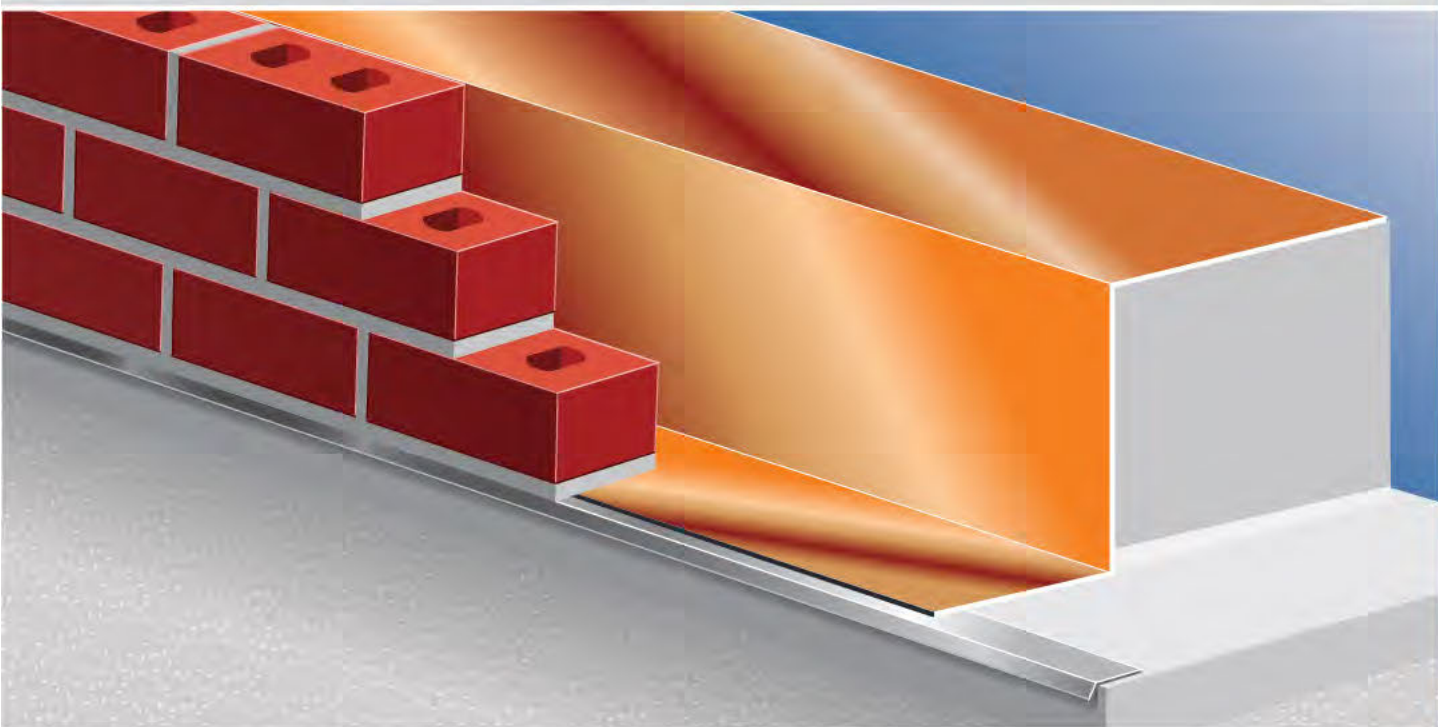



Why Pre-Formed Flashing & Metal Systems?

“Preformed” means no cutting, bending or forming on the jobsite. Sandell’s Preformed Flashing & Metal Systems are used in conjunction with other flashing to create a moisture barrier that upholds a watertight environment, and maintains structural integrity. These systems are durable, economical and – best of all – simple to use.

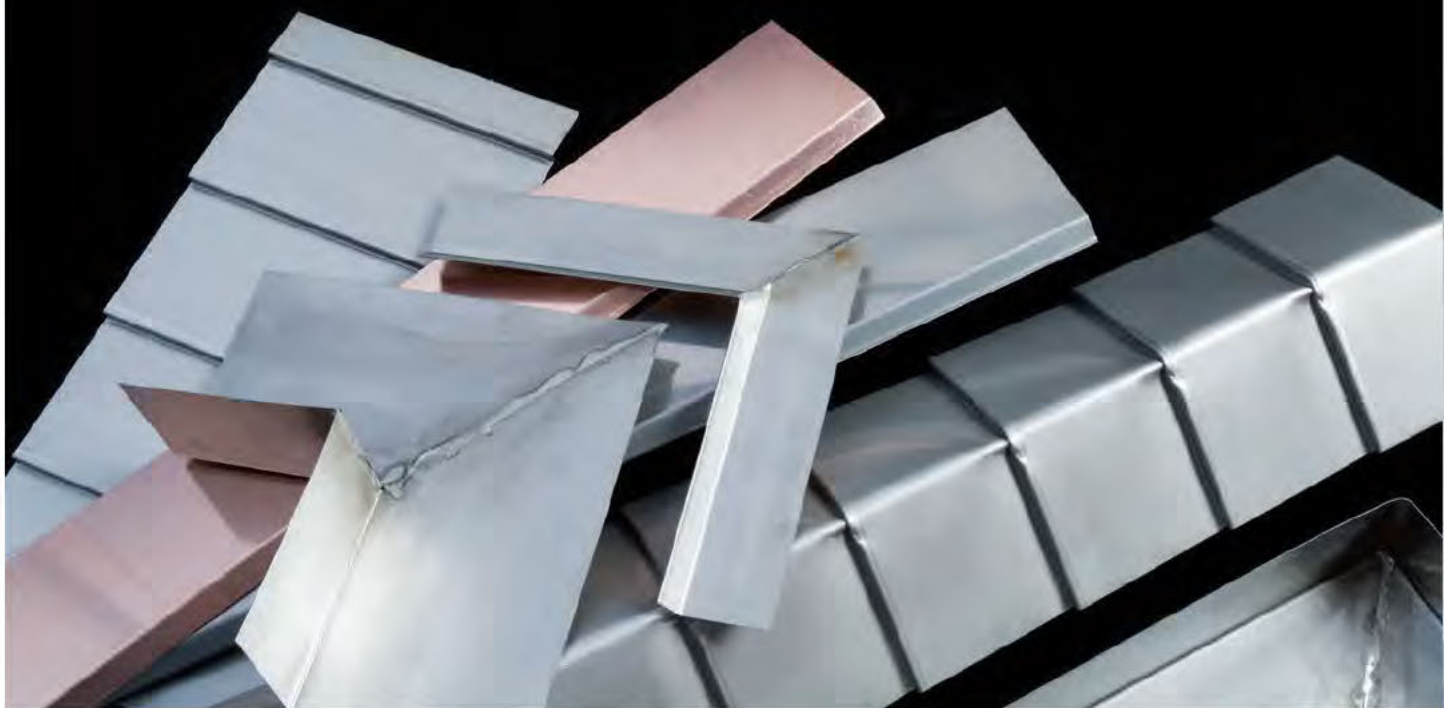

1 Drip Edge

Sandell® Drip Edge™ repels moisture on contact by directing it away from the exterior of the building surface. It provides a durable and aesthetically appealing finish for thru-wall or exposed flashing applications.

- ◆ Prevents unsightly staining, discoloration and water damage
- ◆ Prevents moisture from traveling inward, such as wind-driven rain
- ◆ Adds an aesthetically appealing finish
- ◆ Manufactured in copper, lead-coated copper, stainless steel and Revere FreedomGray™

Sizes:

- ◆ 8' or 10' lengths

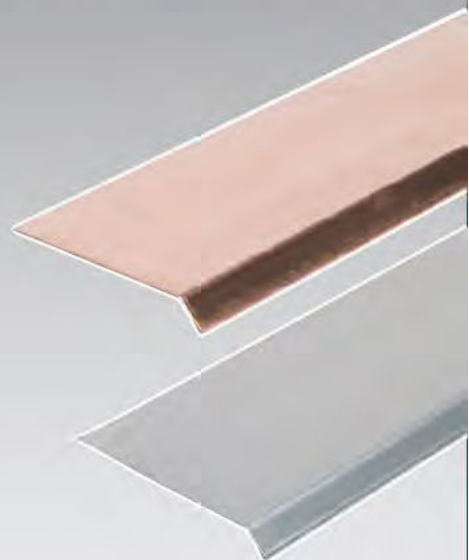

End Dams

These dams are used in conjunction with flashing and other waterproofing accessories to insure moisture protection. As with flashing, they direct moisture to the exterior of structures. Sandell's End Dams should be installed at longitudinal ends of flashing, over lintels, at column abutments, near building expansion joints or when flashing interruptions occur. Self-Adhering End Dams are composed of rubberized asphalt which contains an adhesive surface and release paper.

- ◆ A pre-formed custom product
- ◆ Copper 10 oz., 12 oz., 16 oz. and 20 oz.
- ◆ Stainless Steel 26g and 28g

Mechanical Key Flashing

Mechanically keyed flashing with 3" intervals creates a watertight seal in masonry structures (some exceptions apply). The tri-level design allows moisture to exit the structure quickly. Use at floor levels, beneath sills, over lintels, continuous at spandrel beams, beneath coping and elsewhere as mandated. Available in Copper and Stainless Steel.

Sizes:

- ◆ Copper 10 oz., 12 oz., 16 oz., 20 oz.
- ◆ Stainless Steel 22 gauge, 26 gauge, 28 gauge

2 Metal Corners (Inside & Outside)

This seamless, durable product creates a watertight moisture barrier. It is pre-formed, which means no cutting, bending or forming on the jobsite. Install by setting in place and overlapping with flashing.

- ◆ A custom product
- ◆ Copper 10 oz., 12 oz., 16 oz. and 20 oz.
- ◆ Stainless Steel 26g and 28g

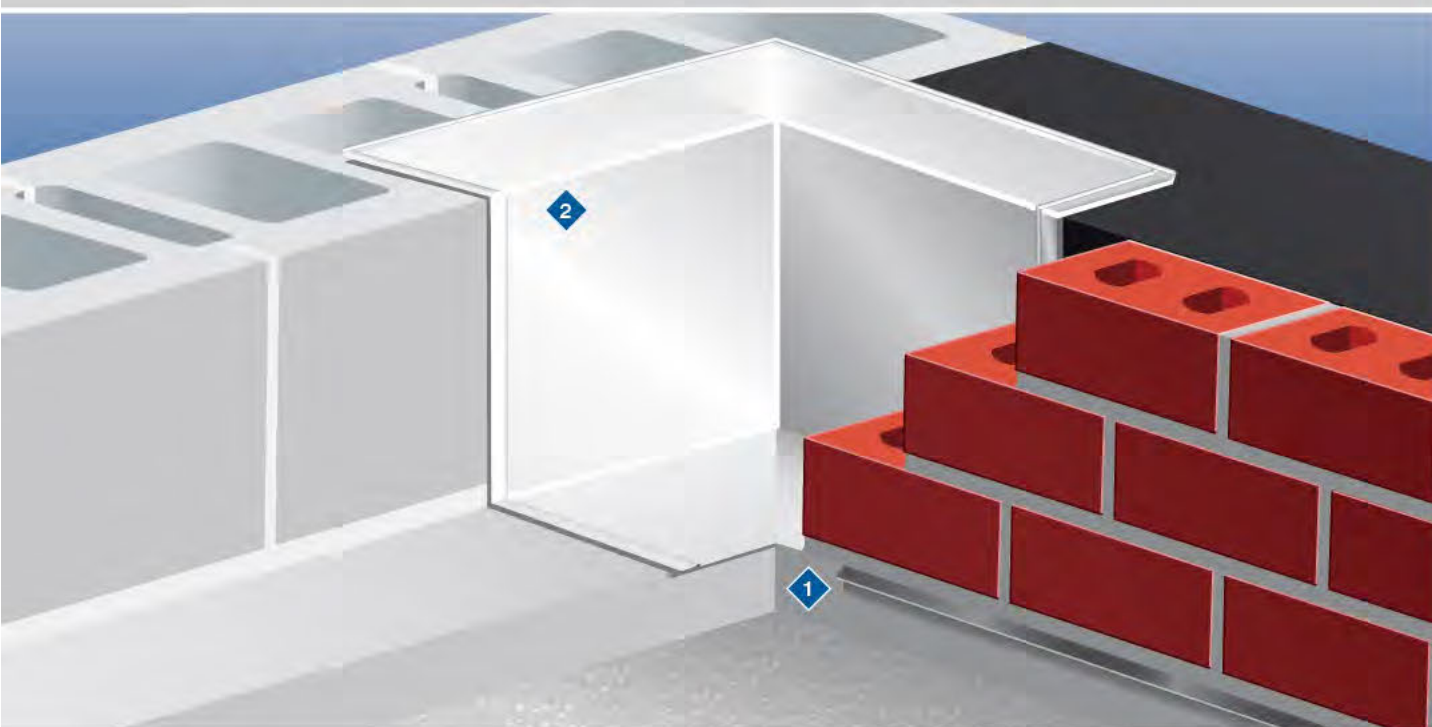

P R E - F O R M E D & M E T A L



Why Synthetic Flashing Systems & Accessories?

Turn to Sandell's Synthetic Flashing Systems & Accessories when cost effectiveness is key. You'll also get ensured moisture protection, application ease and good aesthetics – making this the material of choice for many commercial contractors and specifiers.



Corners (Inside & Outside, Plain & Self Adhering)

This seamless, durable product creates a watertight moisture barrier. It is pre-formed, which means no cutting, bending or forming on the jobsite. Install by setting in place and overlapping with flashing. Sandell's Self-Adhering Corners are composed of a rubberized asphalt, which contains an adhesive surface with release paper. Install by removing the release paper and setting the corner in place; the flashing is then overlapped and adhered to corner for extended protection. Corner is made to wrap.

End Dams (Plain & Self Adhering)

These dams are used in conjunction with flashing and other waterproofing accessories to insure moisture protection. As with flashing, they direct moisture to the exterior of structures. Sandell's End Dams should be installed at longitudinal ends of flashing, over lintels, at column abutments, near building expansion joints or when flashing interruptions occur. Self-Adhering End Dams contain an adhesive surface and release paper.



EPDM

Sandell has revolutionized EPDM manufacturing technology with cured membrane, the first single-ply flashing material that is truly clean. This cost-effective product offers application ease and excellent aesthetics, making it the membrane of choice for many masonry contractors, specifiers and building owners.

Sizes:

- ◆ 100' rolls in widths of 12", 18", 24" or 36"
- ◆ Custom sizing available on request



Nuflex

Sandell's Nuflex Flashing is intended for use as a low-cost, concealed waterproofing membrane on foundation walls and under concrete slabs. The non-reinforced polyvinyl chloride, waterproofed, impermeable sheet will not be deformed when stretched at room temperature, nor will it tear or rip. The material is suitably stabilized to resist exposure without physical deterioration, and is resistant to acids, alkalis and caustics.

Sizes:

- ◆ Type 10 (.010") weighing approx. 11 oz. per sq. yd.
- ◆ Type 20 (.020") weighing approx. 22 oz. per sq. yd.
- ◆ Type 30 (.030") weighing approx. 33 oz. per sq. yd.
- ◆ Type 40 (.040") weighing approx. 36 oz. per sq. yd.
- ◆ Type 60 (.056") weighing approx. 60 oz. per sq. yd.

Roll Sizes: Type 10, 20 & 30 rolls 150' long, 48" wide
Type 60 rolls 100' long, 48" wide



Rubber Seal

Sandell's innovative Rubber Seal Flashing is made of recycled rubber tire material, and surpasses all-asphalt and PVC-based membrane flashings with its superior ability to withstand high heat temperatures and UV exposure. Environmentally friendly recycled rubber makes this product extremely durable and resistant to leaching, dripping and staining. The product is easy to position and apply with its newly formulated self-adhesive backing that is twice as tacky.

Sizes:

- ◆ 3", 4", 6", 9", 12", 16", 18", 24" and 36" widths
by 75' lengths



Sando-Seal

Sandell's Sando-Seal is a self-adhering, 40-mil, in-wall flashing membrane for use with concrete masonry, gypsum or wood wall construction. Composed of a highly adhesive rubberized asphalt compound, and integrally bonded to a high density, cross-laminated polyethylene film, these two materials provide strong and flexible waterproofing layers that ensure moisture protection.

Sizes:

- ◆ 75-foot rolls, and 6", 12", 16", 18", 24" and 36" widths



SYNTHETIC FLASHING



Why Flashing Mastics & Primers?

Flashing mastics and primers dry to a tough, flexible and elastic protective coating. They are highly resistant to the penetration of water and moisture to prevent in-wall damage over a wide range of temperature and service conditions – and, they provide excellent adhesion properties. All mastic and primer products are manufactured in proper consistency for easy application.





Nuflex Mastic

A tacky, fast-grabbing, semi-pressure-sensitive rubber/resin base adhesive designed for bonding Sandell Nuflex to itself or to metal, wood or concrete as well as other porous and non-porous surfaces. Also excellent for bonding other materials such as Tedlar, neoprene, asbestos and foamed polystyrene. Unlike asphalt mastics that cause plasticizer migration when used with PVC, Sandell Special Nuflex Mastic is compatible with all PVC and polyethylene materials, as well as asphalt materials.

Sizes:

- ◆ 5 gallon pails
- ◆ Covers approx. 25 sq. ft. per gallon



Sando-Dry Mastic

Sando-Dry is a solvent-based rubberized asphalt mastic, with excellent adhesion to Sandell Advanced Composites, structural concrete, masonry, wood and stone.

Sizes:

- ◆ One quart (0.9 L) cartridges
- ◆ 1/4" bead covers area approx. 2" wide by 850' long



S-600 Primer

This solvent-based, high tack primer is specially formulated to provide good initial adhesion and excellent permanent adhesion for Sandell's Sando-Seal. It preconditions all structural concrete masonry surfaces on which the Sando-Seal membrane is to be applied, and may be applied by explosion proof sprayer, roller or brush.

Sizes:

- ◆ 5 gallon pails
- ◆ Covers approx. 250 – 300 sq. ft. per gallon



Trowel Mastic

This cut-back asphalt containing long-fibered material is manufactured to a trowel grade consistency which will provide an easy to apply, durable elastic coating that is highly resistant to weathering, and provides excellent adhesion properties. It can also be used as a general-purpose cement for repairing leaks in asphalt roofs, metal roofs, chimneys, flues, down spouts and concrete.

Sizes:

- ◆ 5 gallon pails
- ◆ Covers approx. 25 sq. ft. per gallon





Why Masonry Anchors & Accessories?

Sandell's Anchors & Accessories are used to secure brick to veneer and metal stud, concrete, masonry and wood backup walls. They transfer loads between the brick and the structural framing, allow for differential movements of the building layers and ensure the strength and integrity of the structure.

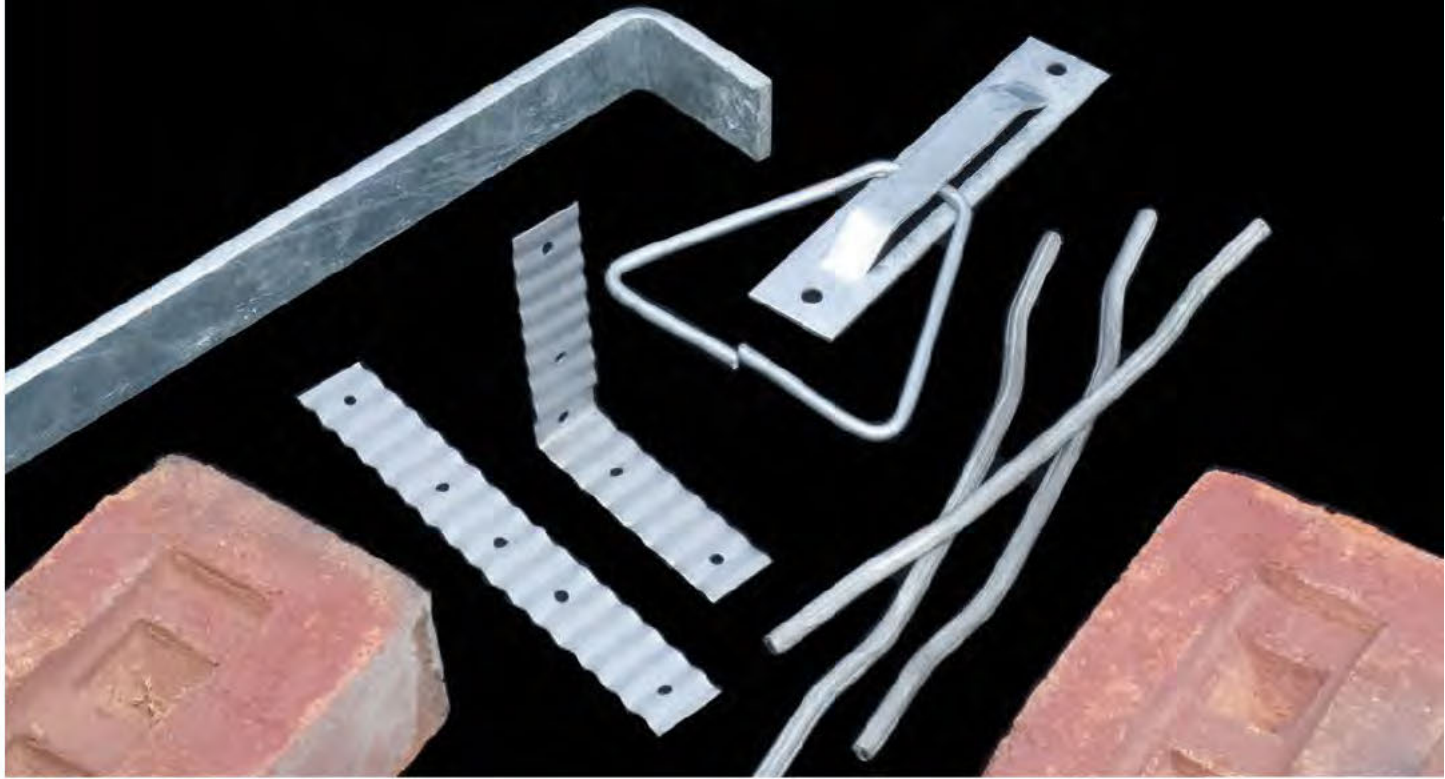

Rigid Masonry Anchors

Used to anchor concrete block, anchors must be strong enough to support high bearing pressure, yet manageable for construction ease. Sandell's anchors offer reliability and easy installation, as well as cost effectiveness. Can be customized easily, and special bends, openings and twists can be implemented on request.

Sizes:

- ◆ 1/8" L- or Z- shaped
- ◆ 2" wide for heavier duty stone weight
- ◆ Custom sizes 1/8" to 3/8" thick
- ◆ Custom 1/8" to 3/8" thick, widths up to 3"



VA Dovetail Tie

This product permits horizontal and vertical movement of the masonry wall while restraining the wall from moving laterally out of its plane. Available in Carbon Steel or Stainless Steel, with Stainless recommended for maximum corrosion protection.

Sizes:

- ◆ Dovetail Head: 14 gauge standard, 12 gauge heavyweight
- ◆ Vee Wall Tie Diameter: 3/16" standard, 1/4" heavyweight
- ◆ Vee Wall Tie Length: 3", 3-1/2", 4", 4-1/2", 5"



VAX

These veneer anchor screw-on plates install quickly, and allow the transfer of compression loads directly to the steel stud backing. The legs pierce through rigid foam insulation and/or glass fiber sheathing, and provide contact with a metal stud. Available in Mill Galvanized, Hot-Dip Galvanized and Stainless Steel.

Sizes:

- ◆ 14 gauge
- ◆ 1-1/4 wide x 5" long
- ◆ Legs sized to accommodate 5/8", 3/4", 1", 1-1/2", 2", 2-1/2", 3" insulation



VA 200

Designed to anchor masonry to a structure accommodating rigid insulation up to and including 3 inches (75mm). In Mill Galvanized, Hot-Dip Galvanized and Stainless Steel. Two fasteners per plate are recommended, and 3/4" to 1" minimum air cavity is required.

Sizes:

- ◆ 12 or 14 gauge plate with leg to accommodate up to 3" rigid insulation thickness
- ◆ Pintle Dimensions: 3", 4", or 4-3/4" long





Corrugated Dovetail Ties

This product permits horizontal and vertical movement of the masonry wall while restraining the wall from moving laterally out of its plane. Available in Carbon Steel or Stainless Steel, with Stainless recommended for maximum corrosion protection.

Sizes:

- ◆ Corrugated Ties available in various sizes



Wall Ties

Sandell's Corrugated Wall Ties are designed to form an excellent bond to mortar or concrete. These corrugated ties are easy to install by nailing or screwing on, and are used to secure brick to block, steel stud or wood framing.

Sizes:

- ◆ 28WT - 7/8" x 7" 28 Gauge
- ◆ 26WT - 7/8" x 7" 26 Gauge / 17 lbs per carton
- ◆ 22WT - 7/8" x 7" 22 Gauge / 28 lbs per carton
- ◆ 20WT - 7/8" x 7" 20 Gauge / 33 lbs per carton
- ◆ 16WT - 7/8" x 7" 16 Gauge / 55.5 lbs per carton
- ◆ Available in Mill Galvanized, Hot-Dip Galvanized and Stainless Steel

Wall Ties are packed 500 per carton



Weld-On Anchors

These wire column and beam anchors tie the masonry wall to columns or beams, and are available in the following finishes: Plain (no coating), Mill Galvanized, Hot-Dip Galvanized after fabrication and Stainless Steel (recommended for maximum corrosion protection).

Sizes:

- ◆ 1/4" x 8" long

1 Anchor Seal

Self-adhering 40 mil. tape is used to seal screws securely.

2 Standard Screws

Fit 1/4" diameter holes of Veneer Anchors.

3 Veneer Anchors

With Triangle Ties, Veneer Anchors are used to secure brick veneer to metal stud, concrete, masonry and wood backup walls, transferring loads between the brick and the structural framing of the building.

- ◆ Available in 14 gauge, mill galvanized or hot-dip galvanized
- ◆ 1-1/4" wide
- ◆ 6" long with 3-3/4" vertical adjustability, or 9" long with 5-1/2" vertical adjustability
- ◆ Furnished with 1/4" diameter holes
- ◆ Weld on or screw in

4 Veneer Triangle Ties

With Veneer Anchors, Triangle Ties secure brick veneer to metal stud, concrete, masonry and wood backup walls.

Sizes:

- ◆ Available in 12 or 14 gauge stainless steel, mill galvanized or hot-dip galvanized
- ◆ 3/16" wire in: 3" x 3", 4" x 4", 5" x 5", 7" x 7", 7" x 9"

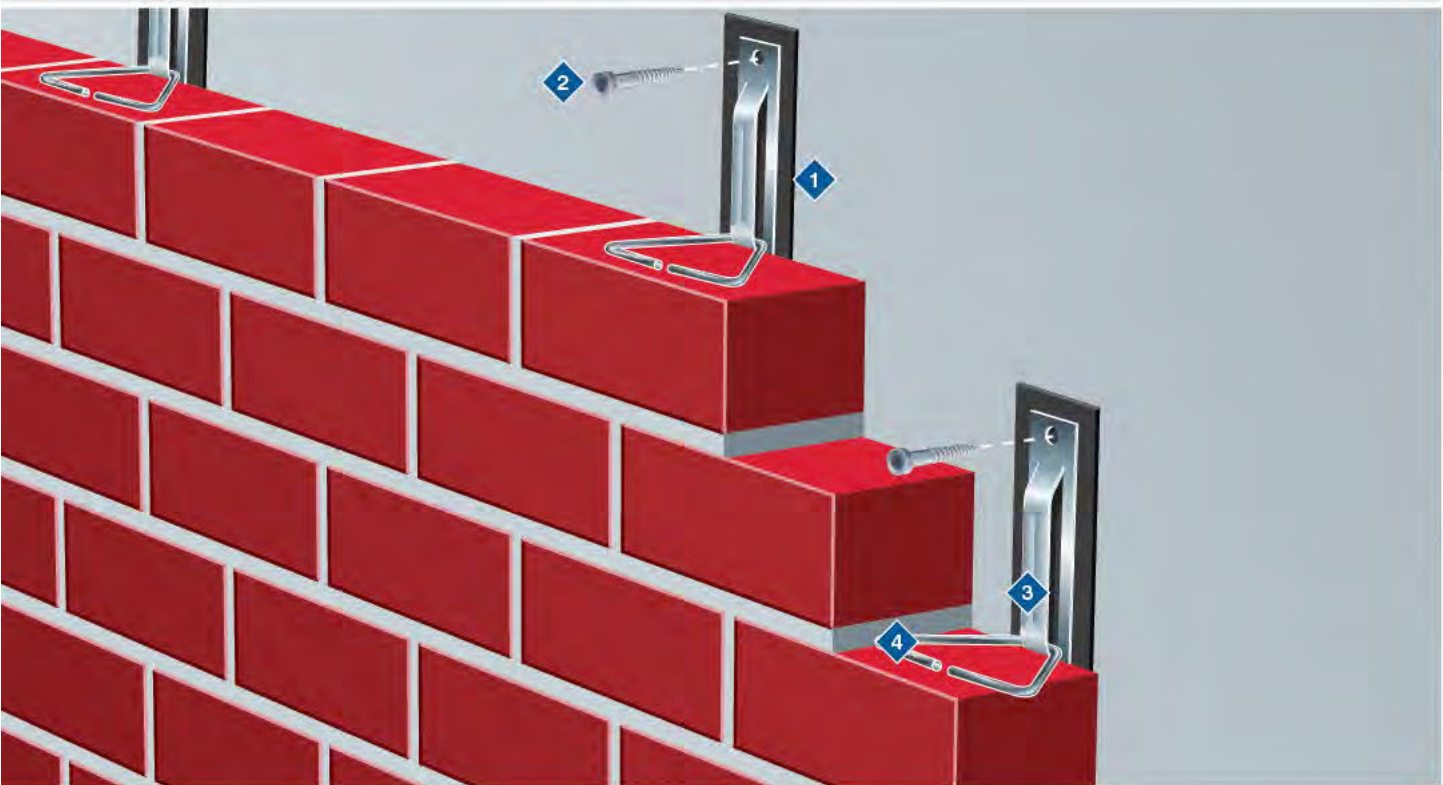



Why Masonry & Concrete Accessories?

These Sandell Masonry and Concrete Accessories are designed to improve the appearance, durability and performance of masonry and concrete systems by repelling bulk water penetration, wicking of moisture and solar-driven moisture movement. They also support fast, efficient and safe masonry/concrete installation.

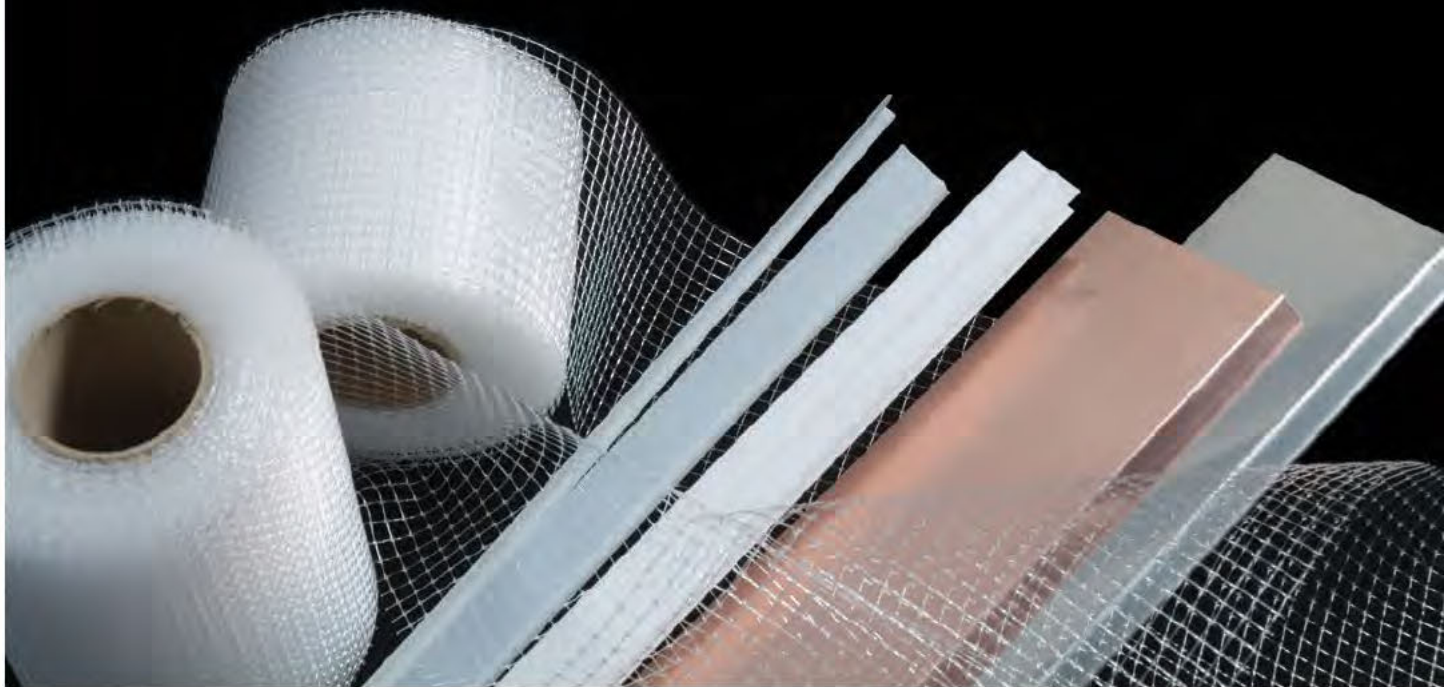

Drip Edge

Sandell® Drip Edge™ repels moisture on contact by directing it away from the exterior of the building surface. It provides a durable and aesthetically appealing finish for thru-wall or exposed flashing applications.

- ◆ Prevents unsightly staining, discoloration and water damage
- ◆ Prevents moisture from traveling inward, such as wind-driven rain
- ◆ Adds an aesthetically appealing finish
- ◆ Manufactured in copper, lead coated copper and stainless steel Revere FreedomGray™

Sizes:

- ◆ 8' or 10' lengths

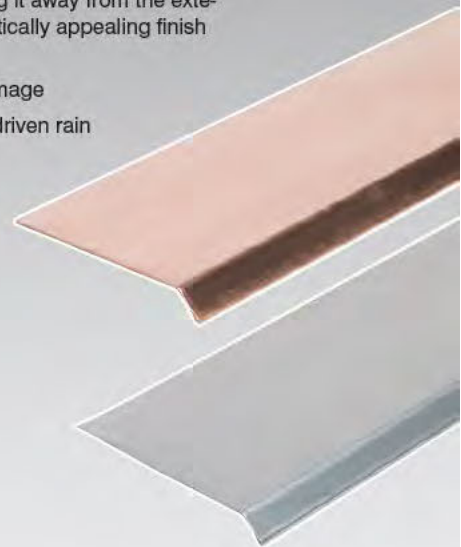

Expansion Joint Cap

This flexible, highly resilient polystyrene product is used to form and fill horizontal and vertical joint applications. It is ideal for molding concrete to maintain uniform edging. Before concrete placement, install on top of the existing expansion joint material to form precise horizontal and vertical intersections within the concrete. With little clean up, the removable top is then snapped off without any effort, and the result is a permanent channel, ready to receive caulk or sealant. Use at any depth, as well as with any other expansion joint product.

Sizes:

- ◆ Available in 10' lengths in the following dimensions:
1/2" x 1/2", 3/4" x 1/2", 1" x 1/2"
- ◆ 500 feet per box



Grout Shield

Sandell's Grout Shield guards against grout and mortar seepage through block cores. By maintaining and regulating the mortar overflow through the block, designated areas are isolated from the common seepage occurrence. The product is composed of a high density, reinforced fiberglass mesh that is capable of enduring high pressure.

Sizes:

- ◆ 100' lengths in the following widths:
4", 6", 8", 10", 12" and 14"



Zip Strips

This revolutionary product is used to prevent random cracking in concrete. It is embedded within the concrete to form a weakened plane joint that limits the range of cracking occurrences within a set area. Since Sandell's Zip Strip eliminates the need for saw cut joints, it is cost effective, cleaner and extremely easy to use.

Sizes:

- ◆ Available in 10' lengths in the following depths: 1", 1-1/2" and 2"





Rebar Caps - OSHA Approved & Mushroom

Sandell®'s OSHA Approved Rebar Caps prevent injury by eliminating potentially hazardous exposed steel on a jobsite. The 4 x 4, brightly colored, high-impact plastic and durable texture provide extensive protection to a construction work zone. The product installs in seconds and readily fits a wide range of diameters, fits rebar #3 and #7. This reusable, environmentally friendly product is in compliance with Federal OSHA standards.

Mushroom Rebar Caps are used as a protective cover for bolts, pipes, rebar and other protrusions that could be potentially hazardous. The bright color creates a visual warning to workers or pedestrians. This device is not intended to prevent impalement or accidental falls, but to reduce possible risks or dangers.

Sizes:

- ◆ Two standard sizes fit a variety of diameters, from 1/2" up to 2.25"



Rebar Positioners

Sandell's Wire Rebar Positioners are designed to position rebar vertically in block cells. They will position two bars, and can be installed after the rebar is in the cell. Available in Mill Galvanized, Hot-Dip Galvanized and Stainless Steel finishes, with Stainless recommended for maximum corrosion protection.

Tensile strength: 80,000 p.s.i

Sizes:

- ◆ Wire Diameter: 9 gauge (.148" or W1.7)
- ◆ Available in double or single
- ◆ Use with 8", 10" and 12" blocks



Termination Bars (Plastic, Aluminum & Stainless)

This product secures flashing in place by using an existing back-up wall or support. Sandell's Termination Bar is easily applied over the flashing, and is screwed into the support wall through the use of self-tapping screws. Available in plastic, stainless steel and aluminum.

Sizes:

- ◆ 1/8" x 1" x 10' sections
- ◆ Pre-drilled hole in stainless steel and aluminum





Why Thermal Expansion & Control Joint Products?

Sandell's Thermal Expansion & Control Joint Products are commonly used for expansion and contraction in vertical and horizontal joint applications. Due to the products' ease of use, it can be applied more rapidly and efficiently as opposed to some costly alternative joint fillers currently on the market. The products form a forceful seal that permanently closes the joint, eliminating the possibility of dirt, moisture and other debris from becoming trapped within the cavity, while permitting movement within the joint.



Backer Rod (open cell)

This is a soft, pliable, round, open cell back-up material used in expansion and contraction joints. It serves as a backing for elastomeric and other applied caulking sealants, and is particularly suited for specialty applications where standard backer rod is not recommended. Its open cell design allows air to pass through both sides of the sealant more rapidly for a uniform cure, so it is not recommended for use in floor joints with self-leveling sealants, or in high traffic areas, where additional support is required. The product is canary yellow or black, and all sizes can be customized.

Common sizes include, but are not limited to:

- ◆ 3/8", 5/8", 7/8", 1-1/8", 1-1/2" and 2"



Backer Rod (standard)

This closed cell polyethylene foam is a round, low density insulation, a non-absorbent back-up material used to control sealant depth. This product is most commonly used in glazing operations, windows, doors, curtain walls, partitions, log home chinking, pavement joints, expansion joints, pre-cast units, isolation joints and copings. Sandell's Standard Backer Rod has a skin-like outer texture that is moisture resistant. Sealant will not adhere to Sandell's Standard Backer Rod, so no bond breaker is required. The product is gray, and all sizes can be customized.

Common sizes include, but are not limited to:

- ◆ 1/4" to 4"

Lite Rod

Sandell's Lite Rod, like our Standard Backer Rod, is used in glazing operations, window and door applications, expansion joints, curtain wall joints, partitions, log construction, pavement joints, precast units and copings. Lite Rod is a closed cell product with a much lower density enabling easier control. It is compatible with butyl, polysulfide, acrylic, polyurethane, silicone and most other cold sealants.

- ◆ Available in: 1/4" to 4" 1/4", 3/8", 1/2", 5/8", 3/4", 7/8", 1", 1-1/8", 1-1/4", 1-1/2", 2"



Cork

Unlike many other products used for expansion and contraction, cork is one of the most durable products on the market today. Sandell's version is manufactured from all-natural components, and available in standard or self-expanding. It will not collapse over time like other fibrous materials, but retains its shape and structural bond perfectly. Sandell's Cork with silicone over the top is the proper choice for insulation; it is fire resistant, does not absorb dust and is non-toxic when burned.

- ◆ Available in 1/4", 3/8", 1/2" and 1" thicknesses

Standard length:

- ◆ 10' long



Rebonded Rubber

This product is a very resilient and flexible bonded rubber joint filler. It is used in concrete structures to compensate for movement, and is ideal for wet areas. Typical applications for this product are sewage treatment plants, power plants, tunnels, airports, reservoirs and dams. It compresses and recovers to over 90% of its original thickness. All sizes can be customized.

Common sizes include, but are not limited to:

- ◆ 1/8" to 2" thickness

Standard length:

- ◆ 5' long

Neoprene (with and w/o PSA)

Composed of 100% closed cells which allow the product to resist moisture and other compounds with ease, Sandell's Closed Cell Neoprene is a highly effective expansion joint filler that provides a lightweight thermal barrier against both heat and cold. It is used for highways, bridge approaches, industrial flooring, and all brick and masonry structures. The product can be tailored to any project, and is available with or without pressure sensitive adhesive.

Common sizes include, but are not limited to:

- ◆ 1/4" to 2" thickness

Standard width:

- ◆ 3"

Standard brick expansion joint width:

- ◆ 3" x 3"



PVC Control Joint / Rubber Control Joint

This PVC Control Joint is manufactured from a flexible PVC compound, conforming to ASTM D-2287-654. It is in compliance with durometer hardness of 80 + 5 Shore A, when tested by conventional ASTM D-2240 tests methods. Used with standard sash block to allow for expansion and contraction of masonry walls. Sandell's Rubber Control Joint is manufactured from a high grade synthetic rubber compound with a durometer hardness of 80 Shore A when tested in conventional ASTM D-2240 test methods. Manufactured to be used with standard sash block to allow for expansion and contraction of masonry walls.

Available in 4-foot sections.

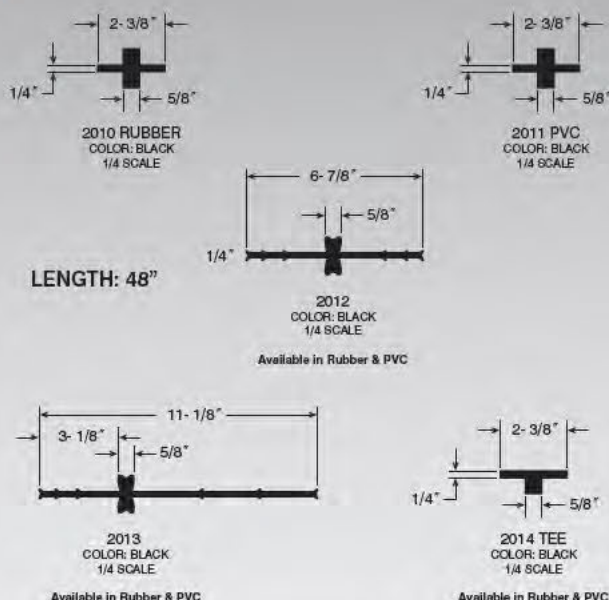

Polyethylene Foam (crosslinked)

This expansion joint filler is available with or without peel top, and is commonly used for expansion and contraction in vertical and horizontal joint applications, including: on driveways, sidewalks, highways, runways, curbs and apron applications. This foam does not pose any health hazards, is environmentally friendly and low in cost for energy efficient construction. The product can be custom cut to fit any application, and does not require bond breaker. It is made for hot applied sealants. Available in Gray.

Common sizes include, but are not limited to:

- ◆ 1/8" to 6" thickness

Standard widths:

- ◆ 1/2" to 60"

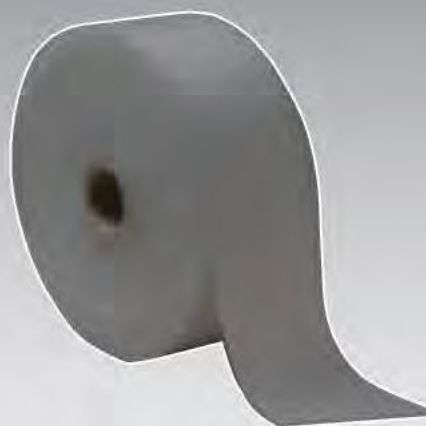

Polyethylene Foam (non-crosslinked)

This expansion joint filler is commonly used for expansion and contraction in vertical and horizontal joint applications, and is available with or without a peel top. It is recommended for cold-applied sealants such as silicone, butyl, polysulfide, acrylic and polyurethane. The unique closed cell structure of this product allows for low moisture absorption. It can be custom cut to fit any application, and does not require bond breaker. Available in black or white.

Common sizes include, but are not limited to:

- ◆ 1/8" to 6" thickness

Standard widths:

- ◆ 1/2" to 60"





Why Weeps & Drainage?

Masonry weeps and drainage devices maximize the life of the structure by allowing moisture to dissipate correctly. They permit moisture to migrate immediately to the exterior of the structure, while encouraging the proper movement of air.



Cell Vents

Sandell's Cell Vents are used to channel moisture to the exterior of a structure through planned openings within the wall. With a unique honeycomb design, debris, insects and obstructions to openings that cause drainage complications are eliminated. In polypropylene plastic, and the following colors: Clear, Gray, Almond, Cocoa Tan, Brown, Ebony and Rust.

Sizes:

- ◆ Standard -
3/8" x 2 1/2" x 3 3/8"
- ◆ Jumbo -
3/8" x 3 1/2" x 3 1/2"



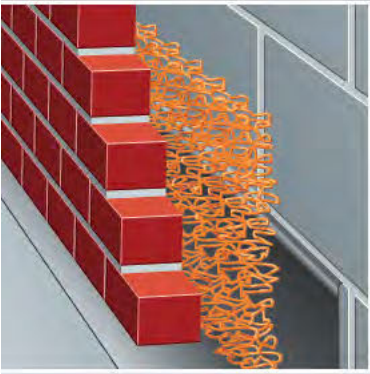

Mortar Web

Sandell's Mortar Web suspends mortar droppings and redirects moisture to the exterior of the structure. Bypassing mortar collection altogether, moisture is able to dissipate correctly and avoid pooling within the wall. The straight cut and recycled heavy fiber weave makes this product more effective than the alternative pea gravel application. Sandell's Mortar Web will not aid in the growth of mold, mildew or fungus. It is equal or superior to other mortar collection devices on the market, but sold at a fraction of the cost.

Sizes:

- ◆ 1" wide x 10" high x 50' long
- ◆ 2" wide x 10" high x 25' long



Rectangular Weeps

Sandell's Rectangular Plastic Weep Tube was specifically designed to sandwich perfectly between brick for an ideal fit, and to properly discharge moisture away from the structure. Available colors are clear or gray.

Size:

- ◆ 3/8" x 1 1/2" x 3 1/2"



Weep Tubes & Weep Tubes with Wicks

Sandell's Round Plastic Weep Holes are used to channel moisture to the exterior of a structure through planned openings within the wall. They are composed of clear PVC, and are extremely durable.





Why Sandell's Air-Tight™ System?

By year-end, sealant standards will be Code required in 32 states. And Air-Tight™ Sealing Systems will exceed those requirements, providing a superior and cost-effective building envelope for today's commercial structures. Control the unintended movement of air and moisture into and out of your building enclosure. Our sealant system essentially "wraps" the building, providing a barrier to water vapor that leaks in (from the inside in heating climates and from the outside in cooling climates), condenses and forms water: a key ingredient to corrosion and mold. Sandell's Air-Tight Sealing System also protects your buildings from suspended particulates, pollutants, dust, insects, odors – anything you want to keep out. Create a building envelope that delivers physical protection from weather and climate (comfort), indoor air quality (hygiene and public health), durability and energy efficiency with Sandell's high-performance products. Air Barrier Association of America approved, VOC-free.

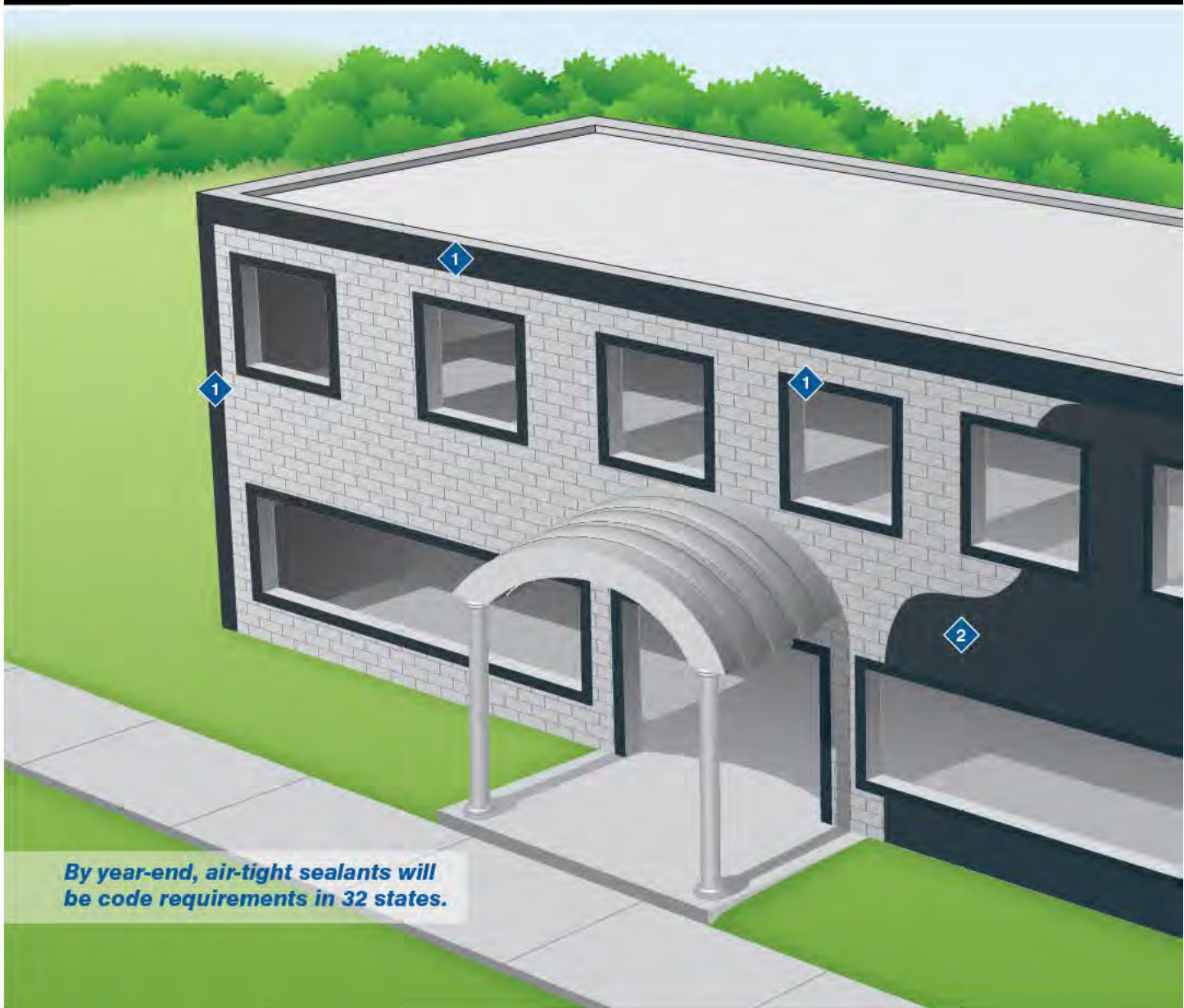

By year-end, air-tight sealants will be code requirements in 32 states.

1 Sandell Air-Tight™ Self-Adhesive Membrane

To be used as part of the Sandell Air-Tight™ System, this is a fully adhered, self-adhering air and vapor barrier membrane for use with concrete masonry, gypsum or wood wall construction. Usage complies with typical wall flashing details. Ideal for hard-to-spray areas, like columns.

- ◆ 18" or 36" x 75'

2 Sandell Air-Tight™ Liquid

This Sandell product is a latex asphalt emulsion air and vapor barrier used as a waterproof coating for a variety of applications and surfaces including metal, wood, concrete and all exterior sheeting. It dries in 15 minutes, offering a tremendous time advantage over standard products, and is fully cured in 24 hours. Air-Tight Liquid is easily applied by brush, squeegee or spray equipment, and covers 25 sq. ft. per gallon. Approved by the Air Barrier Assoc. of America, ICC approved for below grade use, 100% Asbestos and VOC free and non-permeable at 40 mil thickness. Spray an entire building to create an air-tight environment.

**Fully Cured
in 24 Hours!**

Sold in:

- ◆ 5 gallon pails
- ◆ 55 gallon drums
- ◆ 270 gallon totes

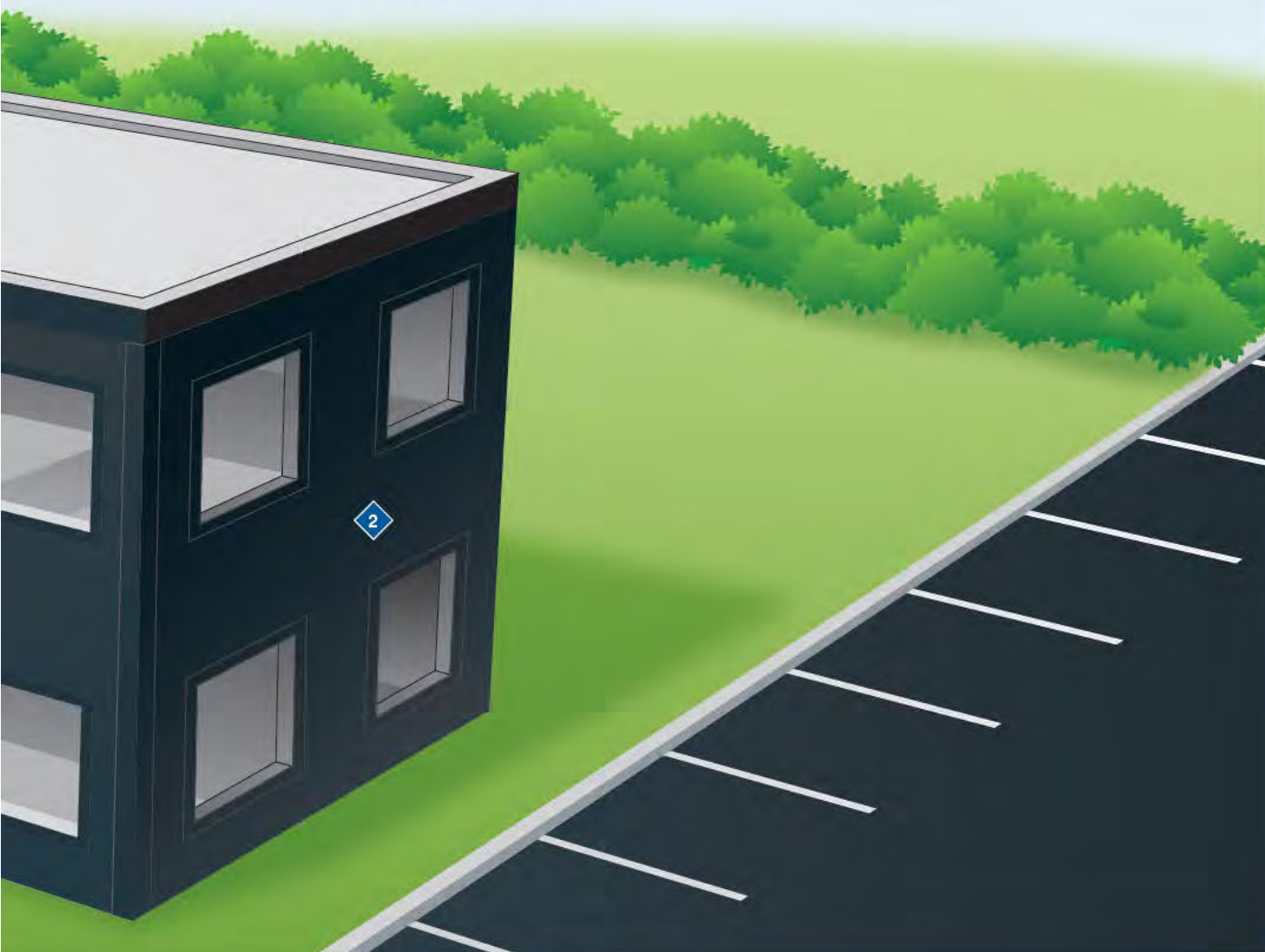

A I R & V A P O R B A R R I E R

Customer success is our focus.

We're proud of the confidence that we've earned from architects, contractors and building owners who appreciate our understanding of the building envelope and our high standards in providing all-season solutions which recognize that every project is important – every project gets the best of our best.

When our name is on your specification, our 70 years of experience and excellence stand behind your name, reputation and application to help deliver the comfort, health, performance and efficiency that your customers expect.





"From single family homes to the most demanding commercial buildings, from masonry walls to roof-tops, our products, our people and our experience are committed to helping your projects succeed. Bring us your toughest challenges – in quality, cost or time – no one will work harder to return the best solution."

Saverio Minucci, CEO
Sandell Construction Solutions

